

The Cultural Development Network in partnership with Latrobe City Council, Wellington Shire Council, Rural and Deaf Access and Regional Arts Victoria **present this one day conference**

Communities, Accessibility and the Arts

Responding to and embracing differences in arts and cultural contexts

Exploring the challenges and opportunities of inclusive arts. Presentations, discussions and workshops, and the 'Mainstreet' exhibition will inform, inspire and energise participants.



The Cat in the Flowers, Rhonda Johnson, 2005

How can we enrich our communities by increasing opportunities for people with disabilities to participate in arts and culture?

Wednesday May 9, 2008
9:30 am – 5 pm

Latrobe Regional Gallery
138 Commercial Road,
Morwell

Followed by the launch
of 'Mainstreet' exhibition

Steering group

Kim Dunphy, Cultural Development Network; Paul Holton, Bill Lawler, Jacqui Hemsley, Latrobe City; Frances Ford, Wellington Shire; Leanne Wishart, Deaf Access Victoria; Deb Milligan, Regional Arts Victoria

Presented by:



This event has been supported by 'Forging the Links' Network Gippsland

New Exhibitions



Instinct and Tradition: Karl Duldig 1902–1986

Until June 15

This exhibition follows the remarkable journey of sculptor Karl Duldig from Vienna to Australia, highlighting his significant contribution to the development of Australian sculpture.

Over fifty sculptures in bronze, marble, steatite and glazed earthenware, as well as a selection of works on paper reveal Duldig's many artistic influences and his resourcefulness in times of adversity. Toured by the Duldig Studio, Melbourne.

Floor talk: Saturday 17 May 2pm

Join Eva de Jong-Duldig of the Duldig Studio as she shares her insights into Karl Duldig's work.



Karl Duldig, Dancing Figure (1), bronze, h.34.8cm, Dancing Figure, bronze, h.34.5cm and Kicking Out, bronze, h.33.8cm (group photo, left to right).

Leica/CCP

Until 11 May

The Fifth Documentary Photography Award

This exhibition showcases 17 photographers working within the genre of documentary photography. Works include a selection of black and white and colour prints from across the country. The photographs are contemporary encounters of real and everyday situations that investigate an array of issues, including war, the intense action of a Queensland rodeo, and nostalgic summertime images on the beach.

Artist talk: Thursday 24 April 4.30pm

Samantha Everton, winner of this award, will present an overview of her contemporary photography practice which has won numerous awards and critical acclaim.



Nigel Brennan, from the series Crossroads, 2003. Lambo print

Latrobe Regional Gallery

Main Conference Room

Lunch and breaks

Workshops

- Gallery 6
- Multimedia Space
- Workshop/Studio
- Meeting Room

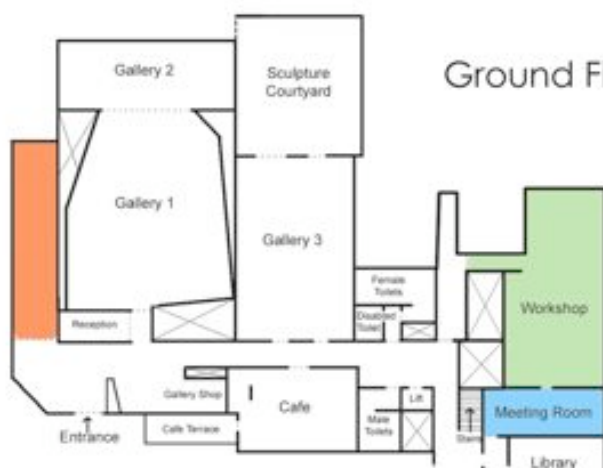

Ground Floor

First Floor

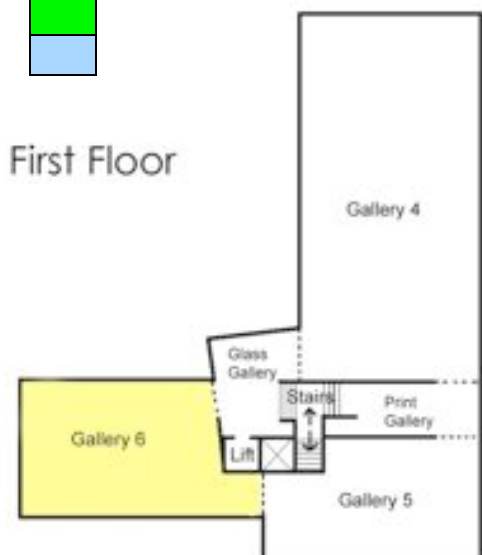

Communities, Accessibility and the Arts

Responding to and embracing differences in arts and cultural contexts

How can we enrich our communities by increasing opportunities for people who have a disability to participate in arts and culture?

- 9.30** **Registration and cuppa** **MC Deb Gray, Liv-to-Liv**
- 9.45** Digital film: *Carlin Street* by John Estlick, Arts Access/ACMI project
- 10.00** Welcome (Gallery 6)
- Welcome to Latrobe – Councillor Bruce Lougheed, Mayor Latrobe City Council
 - Aims of the day – Bill Lawler, Rural Access worker, Latrobe City Council
- 10.25** David Baillie, Department of Human Services, Gippsland Region
Working together for inclusive and creative communities
- Keynote speaker: Ross Barber, Executive Director, Accessible Arts Qld.
Creative Pathways: Opening the Door to More Inclusive Arts
- 11.05** Brief introductions in groups
- 11.20-11.50** **MORNING TEA**
- 11.50** Cathy Horsley, Arts Access Development Officer, City of Port Phillip,
Supporting Inclusive Arts Practice: the challenges and opportunities in local government
- Jacque Robinson, Manager, Rawcus Theatre Company,
Making Art with People of Different Abilities: Creative Partnerships
- Panel of local practitioners**
- Darren McCubbin, performer, producer and Mayor of Wellington
Making Art and Thinking Inclusively
- Emily Ardley with Marilyn Ardley, Rollercoaster Theatre
Making Theatre: A Young Person's Perspective
- Mario Christou, Gippsland Accommodation and Rehabilitation Support Service
The artist's perspective: working in a mental health setting
- Jacqui Hemsley, Able Hands program, Latrobe Regional Gallery
Inclusive programming in the gallery
- Survey: Mapping arts and disability across Victoria, Office for Disability project**
- 1.15- 2.15** **LUNCH**

Communities, Accessibility and the Arts

2.15 Workshops

Making Inclusive Theatre, Jacque Robinson, Rawcus Theatre Company
Gallery 6, upstairs. Facilitator: Leanne Wishart

A participatory workshop introducing the process and approaches used by Rawcus in creative development.

Taste, Touch and Smell Tell Stories Too,

Jodie Ahrens, producer, director, designer, Roundangle Theatre Company.
Studio/Workshop Room, Ground Floor. Facilitator: Deb Milligan

Experience alternative perspectives on communication methods and gain insight into some of the issues faced by people with sensory impairment, working with blindfolds to stimulate all the senses for increased physical and spatial awareness. Small groups will work together telling stories using only taste, touch and smell.

Creative Music and Dance ideas for non-experts, Kim Dunphy

Multimedia Space, Ground Floor. Facilitator: Jacqui Hemsley

Simple and enjoyable ideas for movement and dance activities that you can use straight away in your classroom, dance studio or day program by Kim Dunphy.
Also featuring the Soundbeam machine

Focus group discussion: *Increasing participation of people with a disability in arts and culture: What can we do? What changes do we want to see?*

Facilitators: Bill Lawler, Frances Ford, John Smithies, Meeting Room, Ground Floor

This session will form part of this area's response to Office for Disability/Arts Victoria Research project being undertaken by the Cultural Development Network.

3.45- 4.00 AFTERNOON TEA

4.00 WRAP UP SESSION *Turning Over a New Leaf*: Gallery 6

Facilitated by Deb Gray and Bill Lawler

What does our Perfect Match picture show? What are we doing with what we have? What more could we do? What else do we need? **Local and other resources** – in two minutes present your idea, resource, project or organisation

5.00 **CLOSE** Thank you for joining us today. We welcome your feedback on form provided.

5.30 Launch of Mainstreet exhibition

Uncommon Sense Textures and Transition

Mainstreet Artworks

A group of remarkable adult artists with intellectual disability, who practice art making together on a weekly basis at the studios of ARC in Yinnar. The Mainstreet Artworks program is managed by Moe Life Skills Community Centre Inc.

International Power Hazelwood
Community Access Gallery



Communities, Accessibility and the Arts

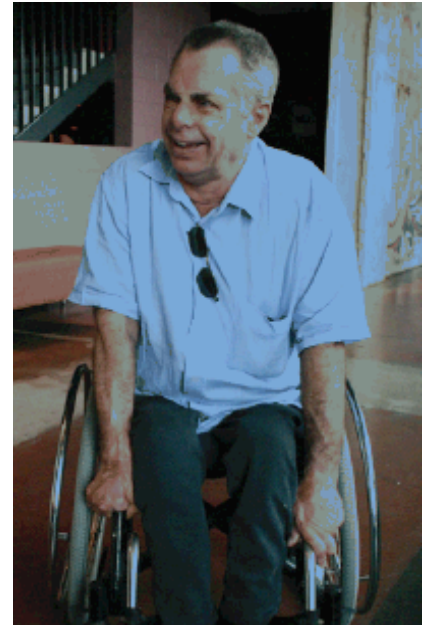

Biographies:

Ross Barber, Executive Director, Accessible Arts Queensland

Ross Barber became Executive Director of Accessible Arts Queensland in 2004, bringing with him much experience in the management of inclusive arts and community cultural development practice and programs. Ross is also acknowledged as a significant professional artist, as he regularly develops and exhibits new installation work. Ross' presentation will inspire us about the possibilities for people with disabilities when doors open.

Jodie Ahrens, Theatre Producer, Director and Designer works in theatre as a producer, director and designer. Driving the multi-sensory work of Roundangle for the past four years, she has recently been investigating smell as a tool for theatre.

Roundangle's first performance, 'Source/Sauce' won several awards at the 2006 Melbourne Fringe Festival

Kim Dunphy, in addition to her role as Manager of the Cultural Development Network, is an experienced community artist, dance teacher and therapist and author of *Freedom to Move: movement and dance for people with intellectual disabilities*. She has lectured in RMIT's Dance Therapy Program and is the Vice-President of the Dance-Movement Therapy Association Australia.

Cathy Horsley, Access Arts Development Officer, City of Port Phillip

Port Phillip is widely acknowledged as a leading council in its support of arts programs that engage people with disabilities. Cathy will discuss some of the successes and also the challenges she faces in her role supporting diverse arts programs.

Jacque Robinson, Manager, Rawcus Theatre Company

Rawcus is a dynamic exchange between artists with and without disabilities producing some of Melbourne's most vibrant and original theatre. Jacque will discuss past, present and future partnerships that Rawcus have enjoyed in creating new and exciting theatre work involving people with disabilities.

Thank you also to Jacqui Hemsley and staff at Latrobe Regional Gallery and I-Gain catering.

The Cultural Development Network is an independent non-profit group that links communities, artists, local councils and organisations across Victoria. We advocate a stronger role for participatory arts and cultural expression to build a healthier, more engaged and sustainable society.

www.culturaldevelopment.net.au



Steering group

Kim Dunphy, Cultural Development Network;
Paul Holton, Bill Lawler, Jacqui Hemsley,
Latrobe City; Frances Ford, Wellington Shire;
Leanne Wishart, DeafAccess Victoria;
Deb Milligan, Regional Arts Victoria